

FERRO Klima

THE CLIMATE-PROTECTIVE FOR A HEALTHY ENVIRONMENT.



5-ply faces



Exterior grade
MDF faces



Flat steel
stabilizer

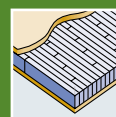

Laminated
core



Robust
construction

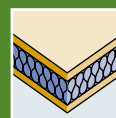

Ecological
solid timber
insulation

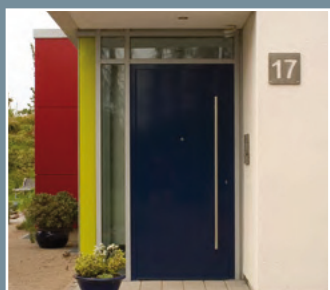
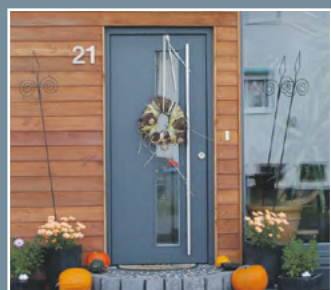

TECHNICAL DETAILS

1/8 DOOR FRAME			
1 Framing/Timber	Finger-jointed and laminated timber framing.		
8 Flat steel stabilizer	Lock-side patented flat steel stabilizer – thermally separated and sound insulated – to absorb tractive and shearing forces. Flat iron straps are glued and friction-locked with the framework.		
Frame width/Options to shorten/Glass apertures		Thickness of door blank 68/78 mm	
		Frame width in mm	can be trimmed by
	Top	127	75*
	Side	lock-side 80/hinge-side 127	lock-side 25*/hinge-side 75*
	Bottom	127	85*
	Minimum distance for glass apertures on all 4 sides: 180 mm. The frame width corresponds to the shortening dimension. Whenn trimmed by a maximum at the bottom (85 mm), a single rebate (max. 18 mm) and/or fitting of drop down seal is possible.		
2 INNER LAYER			
Construction	Quality-proven with long-term experience – Sandwich construction of laminated core (pine) and ecological solid timber insulation – Well surface stability through vertically aligned annual rings		
Bonding	Free of formaldehyde		
3-7 COVER BOARD			
Bonding	AW bonding according to DIN 68705 T2 – 5 layers (noble veneer, longitudinal) – 3 layers (cross grained veneer) = can be veneered individually Full-surface bonding with the overall construction		
EXTERNAL DOOR BLANK			
Model/finish	Cut and sanded		

* with a max. rebate of 30 mm.

EXAMINATIONS AND TESTS

LENGTH IN MM	2,110/2,240/2,470
WIDTH IN MM	950/1,050/1,150
THICKNESS IN MM	68 (66*) / 78 (76*)
DIFFERENT CLIMATE TESTING	
DIN EN 1121 : 2000-09	test climate „c“
DIN EN 1121 : 2000-09	test climate „d“
DIN EN 1121 : 2000-09	test climate „e“
TOLERANCE CLASSES (by using three hinges)	
DIN EN 12219 : 2000- 6	3
THERMAL TRANSFER COEFFICIENT	
U-value (W/m²K) according to EnEV	1.04/0.95
SOUND INSULATION	
DIN EN ISO 717-1 R _w [dB]	32-37
BURGLAR-RESISTANCE	
DIN ENV 1627 : 1999-04	RC2/RC3
WEIGHT: 2,240 X 1,050 MM KG/PIECE	65/74

* cross veneered



PRODUCT RANGE

FERRO KLIMA – 68 MM / 78 MM							
Length in mm	2,110 (1,950*)		2,240 (2,080*)			2,470 (2,310*)	
Width in mm	950	1,050	950	1,050	1,150	1,050	1,150
Mahogany	▲	▲	▲	▲	▲	■	■
Okoume	▲	▲	▲	▲	▲	■	■
Meranti	▲	▲	▲	▲	▲	■	■
Oak	▲	▲	▲	▲	▲	■	■
Pine	▲	▲	▲	▲	▲	■	■
Spruce	▲	▲	▲	▲	▲	■	■
Larch	▲	▲	▲	▲	▲	■	■
Paint-grade	▲	▲	▲	▲	▲	■	■
MDF exterior	▲	▲	▲	▲	▲	■	■
FERRO KLIMA – 66 MM / 76 MM							
Length in mm	2,110 (1,950*)		2,240 (2,080*)			2,470 (2,310*)	
Width in mm	950	1,050	950	1,050	1,150	1,050	1,150
Cross grained PV	▲	▲	▲	▲	▲	■	■

* minimal dimension ■ order-based production ▲ available in 5 working days PV = peeled veneer face

All veneer surfaces = cut veneer or fine-line

Further dimensions, sizes and facings on request.

Any Questions? Info-Hotline: +49 8041 508-112 www.moralt-ag.com
Moralt AG, Lenggrieser Straße 52, 83646 Bad Tölz, Telefon: +49 8041 508-0, Telefax: +49 8041 508-218, E-Mail: werk.badoelz@moralt-ag.de

This information is according to the present state of knowledge and does not represent an assurance of properties. Existing laws and regulations are to be followed by the recipient of our products at his own responsibility. All information refers solely to products by Moralt AG.

FERRO Klima

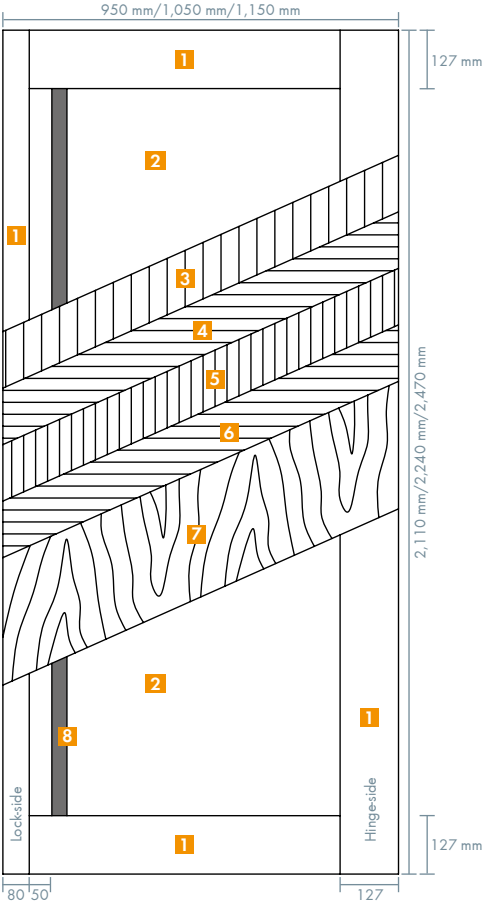

- 1 Solid timber frame
- 2 Laminated core layer
- 3-7 Cover board
- 8 Flat steel stabilizer
- 9 Heath-insulating leight-weight wood

Cross-section view lock-side

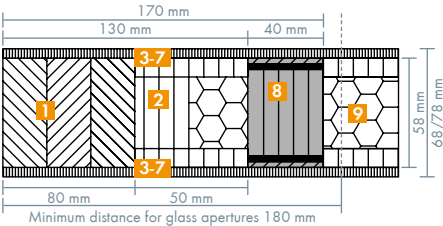

Cross-section view hinge-side

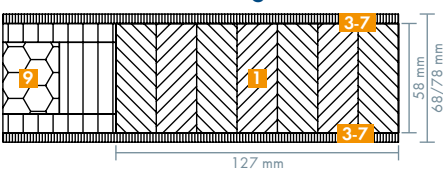

CNC-processing service

CNC processing on request.

Despatch of single cargo

Direct delivery of a single piece to the manufacturer is possible.

Profi-Net timber distributor

