

## FERRO Akustik

# THE NOISE ABSORBER FOR HEAVENLY SILENCE.



New  
decors and  
sizes



5-ply faces



Exterior grade  
MDF faces



Flat steel  
stabilizer

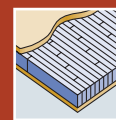

Laminated  
core



Robust  
construction



Acoustic  
insulation



TECHNICAL DETAILS

1/8 DOOR FRAME			
1 Framing/timber	Finger-jointed and laminated timber framing.		
8 Flat steel stabilizer	Lock-side patented flat steel stabilizer – thermally separated and sound insulated – to absorb tractive and shearing forces. Stabilizers are glued and friction-locked with the framework.		
Frame width/Options to shorten/Glass apertures		Thickness of door blank 68 - 98 mm	
		Frame width in mm	can be trimmed by
	Top	127	75*
	Side	lock-side 80/hinge-side 127	lock-side 25*/hinge-side 75*
	Bottom	127	85*
	Minimum distance for glass apertures on all 4 sides: 180 mm. The entrance width corresponds to the shortening dimension. When cut to minimum length at the bottom (85 mm/SSK4 10 mm), a single rebate (max. 18 mm) or fitting of drop down seal is possible.		
2 INNER LAYER			
Construction	– Sandwich construction of laminated core (spruce) including sound insulation – Surface stability through vertically aligned annual rings		
Bonding	Free of formaldehyde		
3-7 COVER BOARD			
Bonding	AW bonding according to DIN 68705 -2 – 5 layers (noble veneer, longitudinal) – 3 layers (cross grained veneer) = can be veneered individually Full-surface bonding with the overall construction		
EXTERNAL DOOR BLANK			
Model/finish	Cut and sanded		
Processing information	The sound insulation can be processed with woodworking machinery.		

\* with a max. rebate of 30 mm

CERTIFICATION

LENGTH IN MM	upto 2,600			
WIDTH IN MM	upto 1,230			
THICKNESS IN MM	68	78	88	98
DIFFERENT CLIMATE TESTING				
DIN EN 1121 : 2000-09	test climate c, d, e			
TOLERANCE CLASSES (by using three hinges)				
DIN EN 12219 : 2000- 6	3*			
THERMAL TRANSFER COEFFICIENT				
U-value (W/m²K) DIN EN ISO 10077-2 : 2012-06	1,2	1,0	0,85	0,78
SOUND INSULATION				
DIN EN ISO 717-1 R <sub>w</sub> (dB)	42-44	42-44	42-47	42-44
BURGLAR-RESISTANCE				
DIN EN 1627 : 2011-09	RC2/RC3*			
WEIGHT: 2,240 X 1,050 MM KG/PIECE	94	98	104	108

\* certified upto height 2,470 mm



PRODUCT RANGE

FERRO AKUSTIK – 68 MM / 78 MM / 88 MM / 98 MM										
Length in mm	2,110 (1,950*)	2,240 (2,080*)	2,370 (2,210*)	2,470 (2,310*)	2,600 (2,440*)					
Width in mm	950	1,050	950	1,050	1,150	1,230	950	1,050	1,150	1,230
Mahogany	▲	▲	▲	▲	▲	▲	▲	▲	▲	▲
Okoumé/Gabun	▲	▲	▲	▲	▲	▲	▲	▲	▲	▲
Meranti	▲	▲	▲	▲	▲	▲	▲	▲	▲	▲
Oak	▲	▲	▲	▲	▲	▲	▲	▲	▲	▲
Knotty oak	▲	▲	▲	▲	▲	▲	▲	▲	▲	▲
Knotty oak 3.5 mm**	▲	▲	▲	▲	▲	▲	▲	▲	▲	▲
Rustic knotty oak	▲	▲	▲	▲	▲	▲	▲	▲	▲	▲
Pine	▲	▲	▲	▲	▲	▲	▲	▲	▲	▲
Spruce	▲	▲	▲	▲	▲	▲	▲	▲	▲	▲
Larch	▲	▲	▲	▲	▲	▲	▲	▲	▲	▲
Knotty larch	▲	▲	▲	▲	▲	▲	▲	▲	▲	▲
White fir	▲	▲	▲	▲	▲	▲	▲	▲	▲	▲
Paint-grade	▲	▲	▲	▲	▲	▲	▲	▲	▲	▲
MDF Exterior	▲	▲	▲	▲	▲	▲	▲	▲	▲	▲
CPL	▲	▲	▲	▲	▲	▲	▲	▲	▲	▲
FERRO AKUSTIK – 66 MM / 76 MM / 86 MM / 96 MM										
Length in mm	2,110 (1,950*)	2,240 (2,080*)	2,370 (2,210*)	2,470 (2,310*)	2,600 (2,440*)					
Width in mm	950	1,050	950	1,050	1,150	1,230	950	1,050	1,150	1,230
Cross grained PV	▲	▲	▲	▲	▲	▲	▲	▲	▲	▲

\* minimal dimension    \*\* cross-grain    ▲ available in 5 working days    PV = peeled veneer face  
All veneer surfaces = cut veneer or fine-line

FERRO Akustik

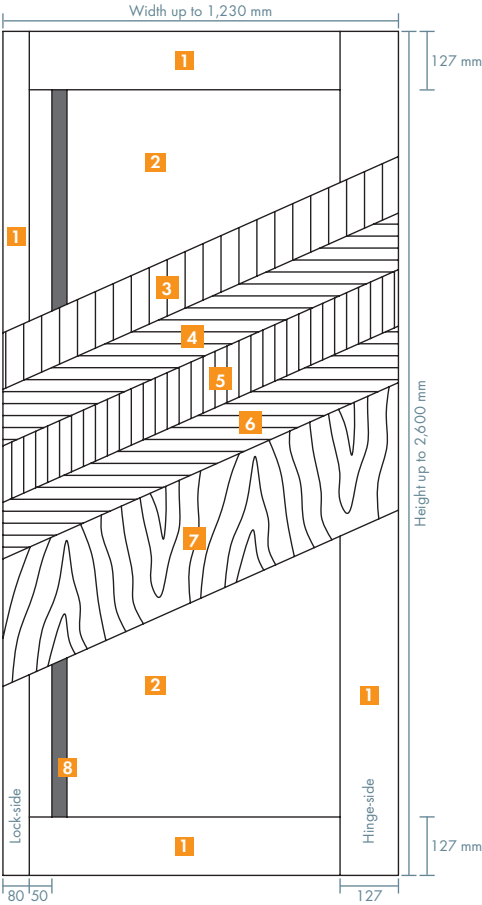

- 1 Framing/timber
- 2 Sandwich system with high heat insulation
- 3-7 Cover board
- 8 Flat steel stabilizer

Cross-section view lock-side

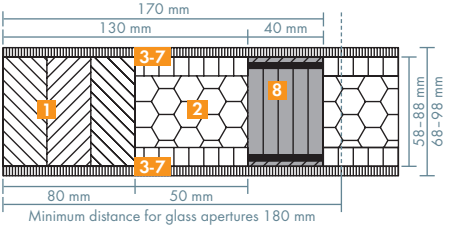

Cross-section view hinge-side

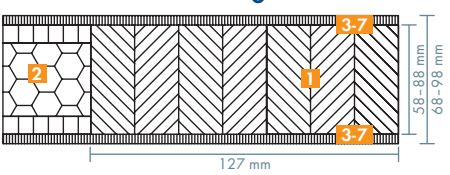

Despatch of single cargo

Direct delivery of a single pieces to the manufacturer is possible.

CNC-processing service

All types may be delivered CNC processed.

Profi-Net timber distributor

Further dimensions, sizes and facings on request.



Any Questions? Info-Hotline: +49 8026 92538-11    www.moralt-ag.com
Moralt AG, Obere Tiefenbachstraße 1, 83734 Hausham, Phone: +49 8026 92538-0, Fax: +49 8026 92538-40, E-Mail: info@moralt-ag.de

This information is according to the present state of knowledge and does not represent an assurance of properties. Existing laws and regulations are to be followed by the recipient of our products at his own responsibility. All information refers solely to products by Moralt AG.